

ANSI 150 Galvanised Backing Ring (5461)
 Stainless Backing Ring (5462)
 Nylon Coated Backing Ring (5464)
 For Example: A 110mm Galvanised Backing Ring Would Have A Code 5461.0110

SIZE (MM)	NOMINAL FLANGE SIZE	INCH SIZE	P (MM)	I (MM)	D (MM)	T (MM)	BOLT HOLES NO X DIA	BOLT
20	15	1/2"	60.5	28	90	11.2	4X16	M14
25	20	3/4"	73	34	100	6	4X14	M12
32	25	1"	79.5	42	108	14.2	4X16	M14
40	32	1 1/4"	89	51	117	15.7	4X16	M14
50	40	1 1/2"	98.5	62	127	17.5	4X16	M14
63	50	2"	120.5	78	152	19	4X20	M18
75	65	2 1/2"	139.5	92	178	22.3	4X20	M18
90	80	3"	152	108	191	23.9	4X20	M18
110	100	4"	190.5	128	229	23.9	8X20	M18
125	100	4"	190.5	135	229	23.9	8X20	M18
125	125	5"	216	135	254	23.9	8X22	M20
140	125	5"	216	158	254	23.9	8X22	M20
160	150	6"	241	178	279	25.4	8X22	M20
180	150	6"	241	188	279	25.4	8X22	M20
200	200	8"	298.5	235	343	28.4	8X22	M20
225	200	8"	298.5	238	343	28.4	8X22	M20
250	250	10"	362	288	406	30.2	12X26	M24
280	250	10"	362	294	406	30.2	12X26	M24
315	300	12"	432	338	482	31.8	12X26	M24
355	350	14"	476	376	533	35	12X30	M27
400	400	16"	540	430	600	36.6	16X30	M27
450	450	18"	578	470	635	39.6	16X33	M30
500	500	20"	635	533	700	43	20X33	M30
630	600	24"	750	645	815	47.8	20X36	M33

Note: these rings are suited to the Stream PE100 Pressure, Stream HDPE, Maxair, and Dynatherm ranges.

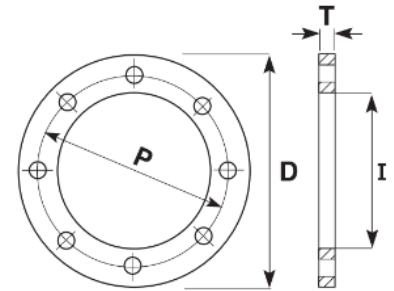

Comments:

Check that both pipe(s) and fitting to be joined are compatible, only compatible materials should be joined together. Check the PN and SDR rating marked on fitting and compare with that of the pipe. If in doubt, seek advice from the manufacturer. Correct installation procedures should be followed.

The designs, materials and specifications shown are subject to change without notice. This is due to the continuous development of our product range

Contact our technical team for further information.

Wellington
 17 Raiha Street, Porirua

Auckland
 3/68 McLaughlins Road, Wiri

P 0800 473 100
E sales@upg.net.nz
W upg.nz