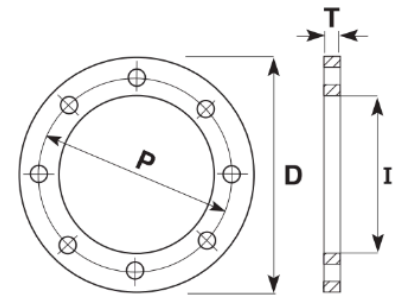



TABLE E Galvanised Backing Ring (5451)
AS 2129 Stainless Backing Ring (5452)
 Nylon Coated Backing Ring (5454)
 For Example: A 110mm Galvanised Backing Ring Would Have The Code 5451.0110

| SIZE (MM) | NOMINAL FLANGE SIZE | INCH SIZE | P (MM) | I (MM) | D (MM) | T (MM) | BOLT HOLES NO X DIA | BOLT |
|-----------|--|-----------|--------|--------|--------|--------|---------------------|------|
| 20 | 15 | 1/2" | 67 | 28 | 95 | 6 | 4X14 | M12 |
| 25 | 20 | 3/4" | 73 | 34 | 100 | 6 | 4X14 | M12 |
| 32 | 25 | 1" | 83 | 42 | 115 | 7 | 4X14 | M12 |
| 40 | 32 | 1 1/4" | 87 | 51 | 120 | 8 | 4X14 | M12 |
| 50 | 40 | 1 1/2" | 98 | 62 | 135 | 9 | 4X14 | M12 |
| 63 | 50 | 2" | 114 | 78 | 150 | 10 | 4X18 | M16 |
| 75 | 65 | 2 1/2" | 127 | 92 | 165 | 11 | 4X18 | M16 |
| 90 | 80 | 3" | 146 | 108 | 185 | 11 | 4X18 | M16 |
| 110 | 100 | 4" | 178 | 128 | 215 | 13 | 8x18 | M16 |
| 125 | 100 | 4" | 178 | 135 | 215 | 13 | 8X18 | M16 |
| 125 | 125 | 5" | 210 | 140 | 255 | 14 | 8X18 | M16 |
| 140 | 125 | 5" | 210 | 158 | 255 | 14 | 8X18 | M16 |
| 160 | 150 | 6" | 235 | 178 | 280 | 17 | 8x22 | M20 |
| 180 | 150 | 6" | 235 | 188 | 280 | 17 | 8x22 | M20 |
| 200 | 200 | 8" | 292 | 235 | 335 | 19 | 8x22 | M20 |
| 225 | 200 | 8" | 292 | 238 | 335 | 19 | 8x22 | M20 |
| 250 | 250 | 10" | 356 | 288 | 405 | 22 | 12x22 | M20 |
| 280 | 250 | 10" | 356 | 294 | 405 | 22 | 12x22 | M20 |
| 315 | 300 | 12" | 406 | 338 | 455 | 25 | 12x26 | M24 |
| 355 | Refer to table AS 4087 B7 PN16 for this size (Page 63) | | | | | | | |
| 400 | 400 | 16" | 521 | 430 | 580 | 32 | 12X26 | M24 |
| 450 | 450 | 18" | 584 | 470 | 640 | 35 | 16x26 | M24 |
| 500 | 500 | 20" | 641 | 533 | 705 | 38 | 16x26 | M24 |
| 560 | - | 22" | 699 | 618 | 760 | 44 | 16X30 | M27 |
| 630 | 600 | 24" | 756 | 645 | 825 | 48 | 16x33 | M30 |
| 710 | 700 | 28" | 845 | 740 | 910 | 51 | 20x33 | M30 |
| 800 | 800 | 32" | 984 | 843 | 1060 | 54 | 20X36 | M33 |
| 900 | 900 | 36" | 1092 | 947 | 1175 | 64 | 24X36 | M33 |
| 1000 | 1000 | 40" | 1175 | 1050 | 1255 | 67 | 24X39 | M36 |



Note: these rings are suited to the Stream PE100 Pressure, Stream HDPE Drainage, Maxair, and Dynatherm PP-RCT ranges.

Comments:

Check that both pipe(s) and fitting to be joined are compatible, only compatible materials should be joined together. Check the PN and SDR rating marked on fitting and compare with that of the pipe. If in doubt, seek advice from the manufacturer. Correct installation procedures should be followed.

The designs, materials and specifications shown are subject to change without notice. This is due to the continuous development of our product range

Contact our technical team for further information.